



17A Dorset Street Epping NSW

4  2  2 

Situated in the heart of the highly desirable Epping neighborhood, this impressive single-level home offers a rare blend of low-maintenance and spacious living. With excellent parks and playgrounds nearby, a quick stroll to Epping Station, and easy access to the town center, this home provides effortless convenience for work and school commutes. Just minutes by car to Macquarie Shopping Centre, the Business Park, Macquarie University, and local hospitals, this location offers an unbeatable combination of accessibility and lifestyle.

Move-in ready with no additional work required, this modern family residence combines the best of city living with the peace and quiet of a serene community.

Type : House
Price : Just Listed
Land Size : 635.7 sqm
View : <https://www.uniland.com.au/sale/nsw/northern-suburbs/epping/residential/house/8174612>



Andy Lin
02 9869 7788



Ti Zhou
02 9869 7788

[For full version visit the website](https://www.uniland.com.au)

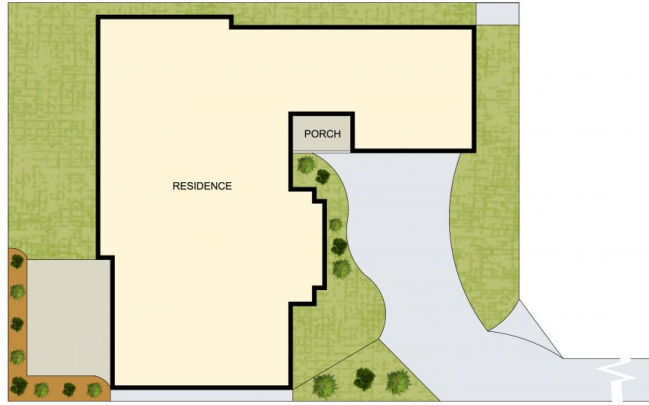

SITE PLAN (NOT TO SCALE)

0 1 2 3 4 5m

Scale in metres. Indicative only. Dimensions are approximate.



DISCLAIMER: PLANS SHOWN ARE FOR MARKETING PURPOSES ONLY, ALL DIMENSIONS ARE APPROXIMATE AND NOT TO SCALE. THEY ARE SUBJECT TO ERRORS AND INACCURACIES AND NO LIABILITY WILL BE ACCEPTED. INTERESTED PARTIES SHOULD MAKE THEIR OWN INQUIRES.

17A Dorset Street, Epping

