



**9/50-54 Cambridge Street Epping NSW**

2  2  1 

Discover an exceptional townhouse in the heart of Epping, offering an unparalleled living experience. This stunning two-bedroom residence boasts a thoughtful design that maximizes natural light and creates a warm, inviting atmosphere. Ideal for young families and downsizers alike, it combines comfort with style.

Enjoy the convenience of being just minutes away from schools, transportation, shopping, dining, and parks-everything you need is right at your doorstep.

**Main features:**

- Sun-drenched and spacious living and dining area
- Gourmet Gas kitchen with stone benchtop and quality appliances
- Two generously sized bedrooms, master have WIR

**Type** : Townhouse  
**Price** : Auction  
**Land Size** : 185 sqm  
**View** : <https://www.uniland.com.au/sale/nsw/northern-suburbs/epping/residential/townhouse/8153543>



**Kris Yu**  
02 9869 7788



**Bryan Peng**  
(02) 9869 7788

[For full version visit the website](https://www.uniland.com.au)

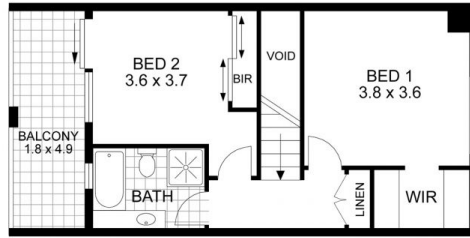

FIRST FLOOR

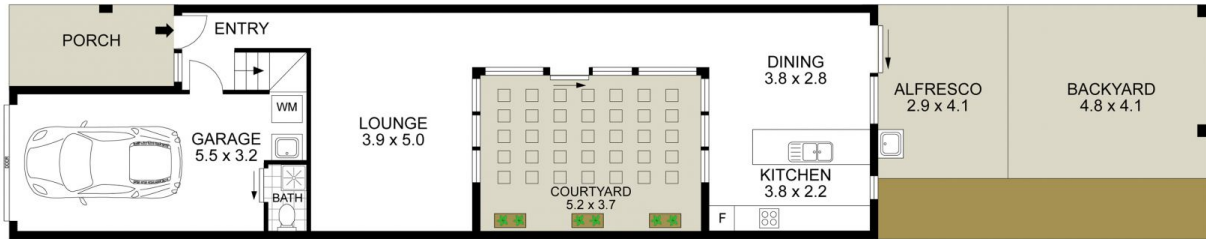

GROUND FLOOR



Disclaimer: Drawing not to scale. Please note that while the information contained in this floorplan is provided by reliable sources, we cannot guarantee its accuracy. It is intended as a guide. Interested parties should rely on their own enquiry

9/50-54 Cambridge Street, Epping

