





**1 Garden Court West Pennant Hills NSW**

5  3  2 

Built in an elegant and classic style in blue ribbon locale of West Pennant Hills, this two-storey brick home is situated in a quiet and private cul-de-sac, it's perfect for your multigenerational family and is within Murray Farm catchment.

This immaculately presented 5-bedroom home is bathed in abundance of sunlight, offers a practical floorplan with multiple living areas, plenty of spaces for entertaining indoors and outdoors, open plan renovated kitchen, spacious bedrooms including a 5th bedroom on the ground floor with easy access to the 3rd bathroom provides options for in-law accommodation or a perfect home office.

Beautifully presented in contemporary tones and along with

[For full version visit the website](https://www.uniland.com.au)

**Type** : House  
**Land Size** : 885 sqm  
**View** : <https://www.uniland.com.au/lease/nsw/hills/west-pennant-hills/residential/house/8085289>

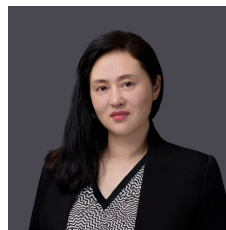

**Lisa Liu**  
**02 9869 7788**



UPPER LEVEL



GROUND LEVEL

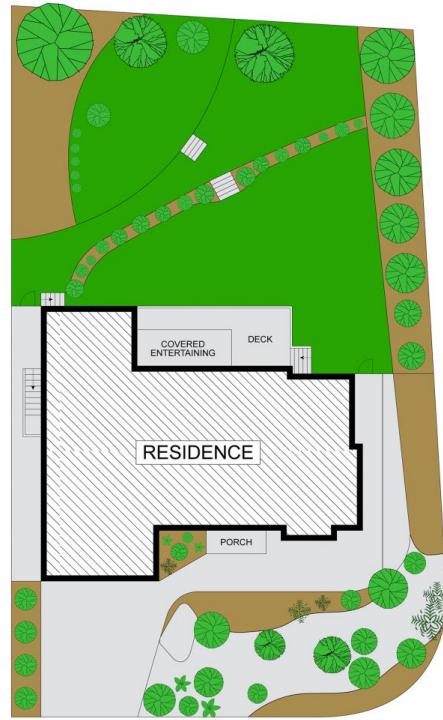

SITE PLAN



Disclaimer: Drawing not to scale. Please note that while the information contained in this floorplan is provided by reliable sources, we cannot guarantee its accuracy. It is intended as a guide. Interested parties should rely on their own enquiry

# 1 Garden Court, West Pennant Hills

