



### 17A Cumberland Street Epping NSW

5 🛏 3 🚿 2 🚗

Calling all families and astute investors! The owners of this fantastic property have bought elsewhere and will be departing this home on Auction day.

Perfect for the busy modern family this Two-Storey brick duplex is located in a highly sought-after street of the leafy northern suburb of Epping. With low maintenance fully landscaped gardens, multiple living areas, easy care floors, spacious bedrooms and separate study nook, this home provides easy living for multi-generational families.

An open plan layout from the gourmet kitchen, dining and family rooms flows to the covered alfresco entertaining zone. A cute balcony from the main bedroom provides the perfect spot for morning coffee and quiet Sundays reading and relaxing away from the rest of the world. With absolutely nothing to do except move in and enjoy, this

**Price** : For Sale Contact agent  
**Land Size** : 418.7 sqm  
**View** : <https://www.uniland.com.au/sale/nsw/northern-suburbs/epping/residential/semi-detached/8011047>



**Andy Lin**  
02 9869 7788



**Kris Yu**  
02 9869 7788

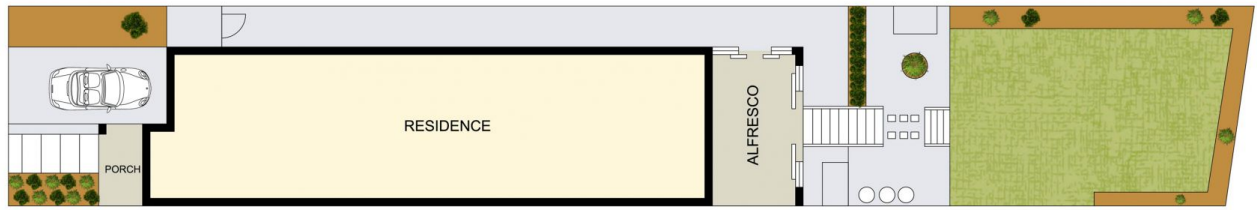
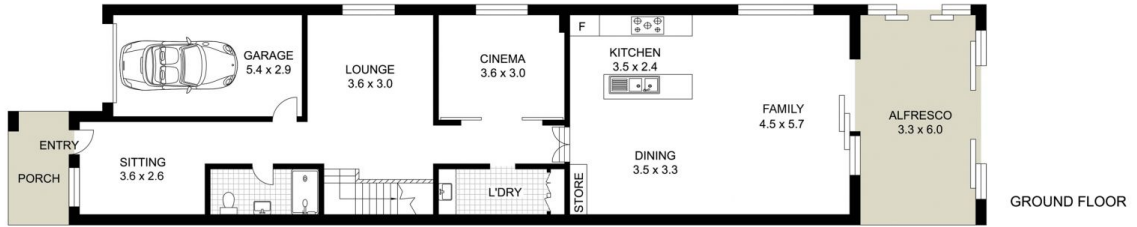

0 1 2 3 4 5m

Scale in metres. Indicative only. Dimensions are approximate.



**DISCLAIMER:** PLANS SHOWN ARE FOR MARKETING PURPOSES ONLY, ALL DIMENSIONS ARE APPROXIMATE AND NOT TO SCALE. THEY ARE SUBJECT TO ERRORS AND INACCURACIES AND NO LIABILITY WILL BE ACCEPTED. INTERESTED PARTIES SHOULD MAKE THEIR OWN INQUIRES.

17A Cumberland Street, Epping

